

HYDRA FIGURE 8 OPERATION MANUAL

This manual will assist you in the operation of the **Hydra Figure 8** unit. Thoroughly read the manual to familiarize yourself with the safe operation of the unit.

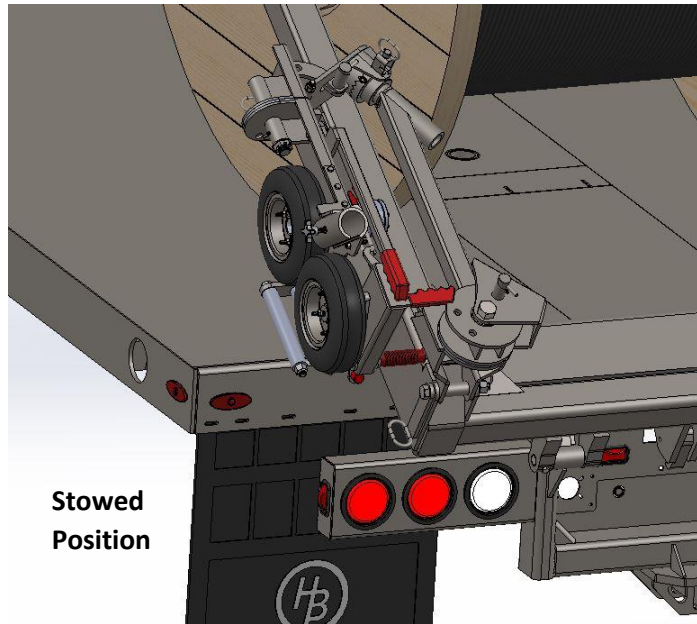

1. From the stowed position, rotate the **Hydra Figure 8** unit to Position 2 by unlocking the pin on the pivot base and re-lock into place. **Figure 1**



WARNING: To prevent accidental injury or loss, keep a firm grasp onto the Figure 8 unit while rotating the pivot base.

Figure 1

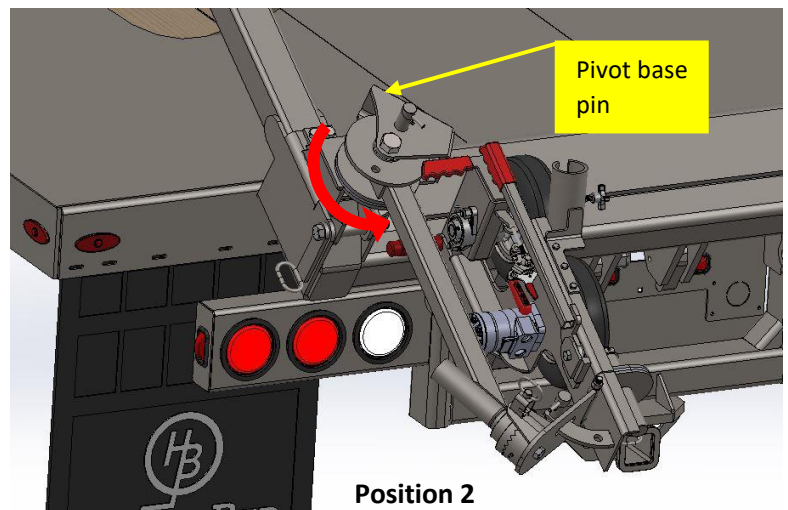

2. Unlock the motor hinge pin, swivel the motor assembly outward and re-lock the pin.

Figure 2

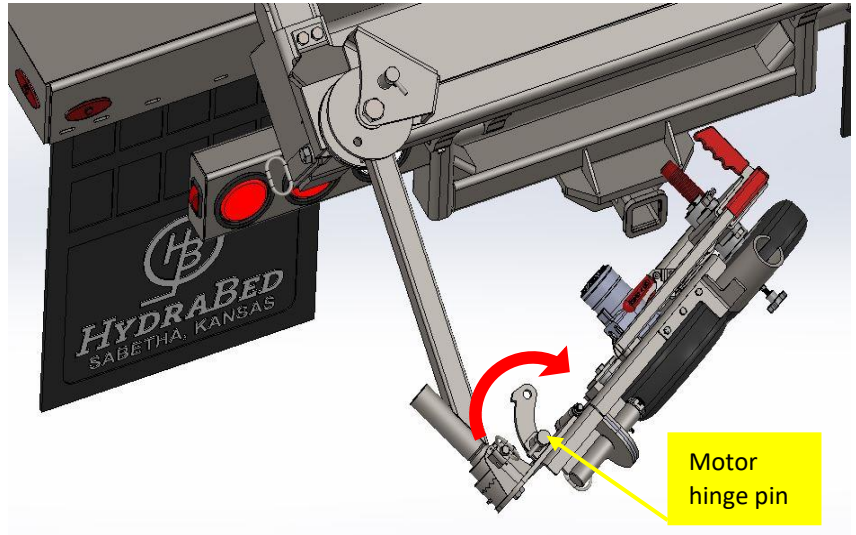

3. Unlock the slip clutch pin and rotate the **Hydra** **Figure 8** motor unit up into the operating position by grasping the red handle at the front of the idler wheel mount and re-lock the pin.

Figure 3 & 4

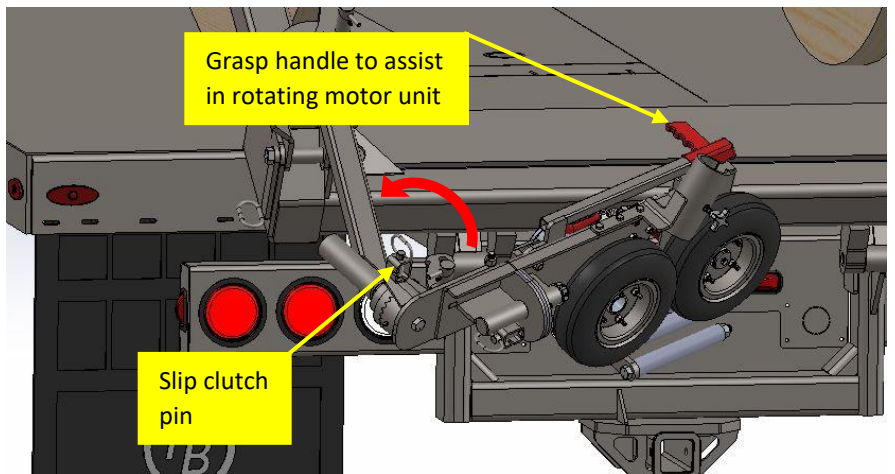

Figure 3

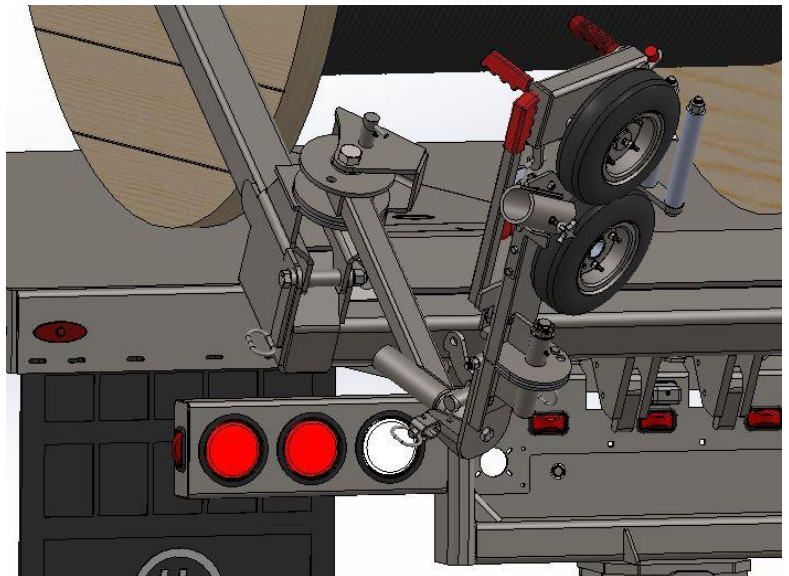

Figure 4

Operating Position

4. Unlock the pivot base pin and swivel the **Hydra Figure 8** unit to the stop and re-lock the pin. **Figure 5**



WARNING: To prevent accidental injury or loss, keep a firm grasp onto the Figure 8 unit while rotating the pivot base.

Figure 5

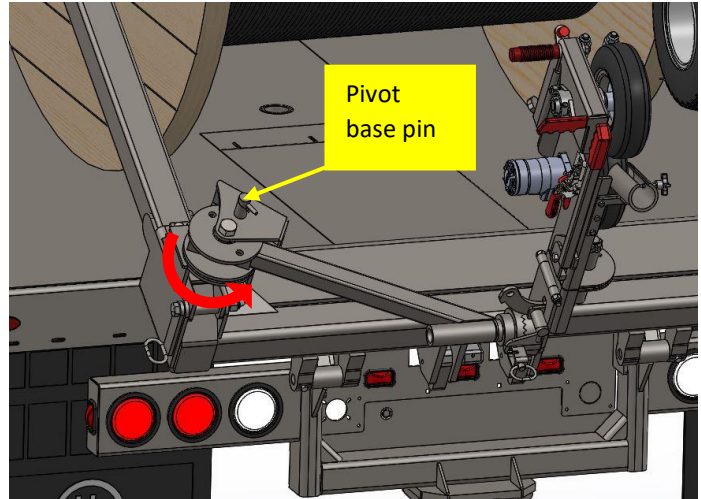

5. Install the PVC cable guide with the slots upward into the cable guide by loosening the thumb screw on the side of it and tighten the thumb screw until the pipe is snug. **Figure 6**

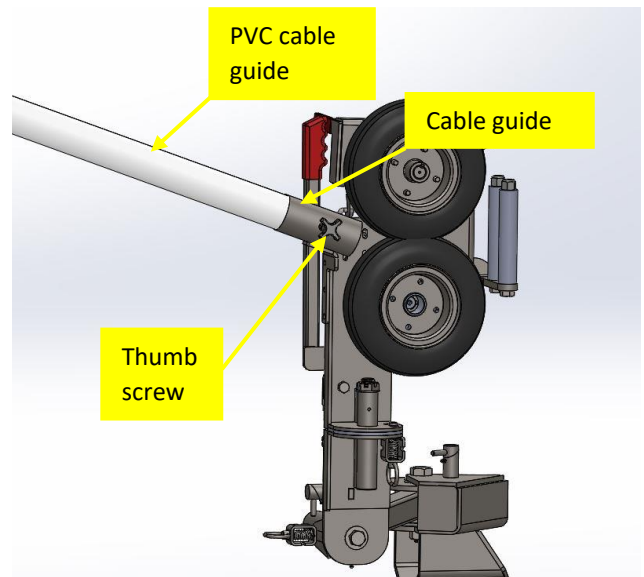

Figure 6

6. Release the draw latch and swivel the idler wheel upwards until it rests on the bumper. **Figure 7**

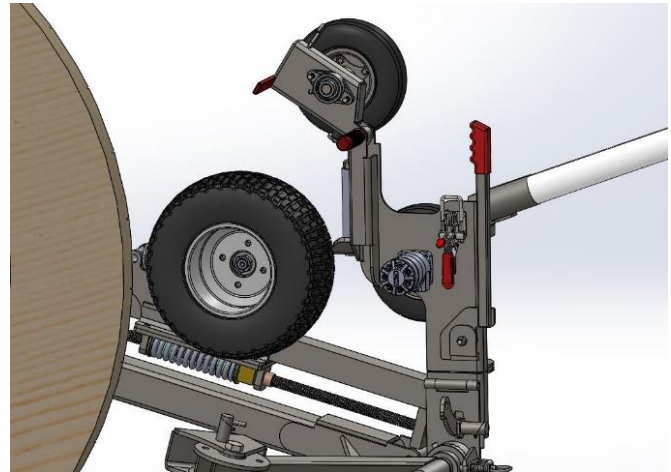

Figure 7

7. Feed the cable to be used between the rollers, on top of the drive wheel and through the cable guides.
8. Rotate the inner PVC cable guide to contain the cable.
9. Put the idler wheel back into position and latch into place. The amount of tension on the cable can be adjusted by loosening the draw latch mount screws and sliding the latch downward or by the draw latch U-bolt nuts.
10. Connect the quick couplers to the Reel Lift toolbox and operate the **Hydra Figure 8** by the Tool Circuit lever pulling the lever towards the operator.

11. The **Hydra Figure 8** unit can be swiveled left and right to help form the figure 8 patterns in the cable by releasing the motor swivel latch and using the handle. The latch can be locked into place so it can be freely moved left and right or locked into one of three positions depending on the user's preference. **Figures 8 & 9**

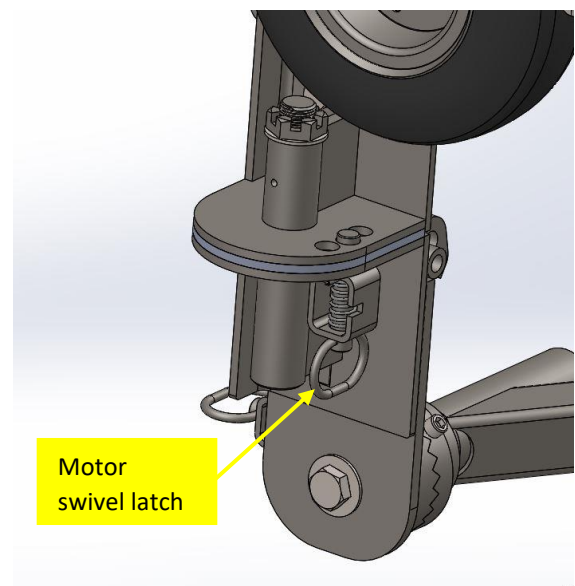

Figure 8

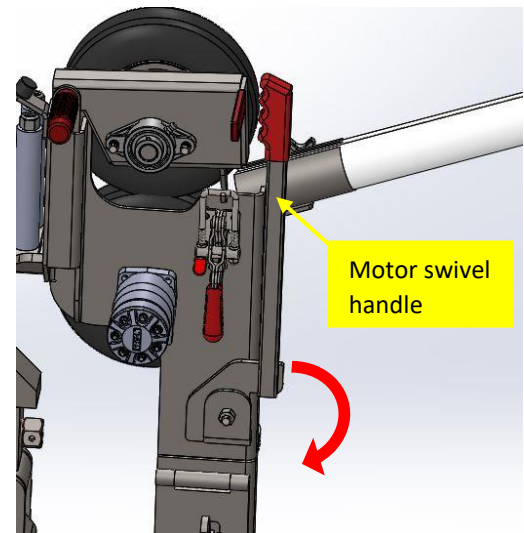

Figure 9

12. To stow the **Hydra Figure 8** unit for transport, remove the PVC cable guides and reverse steps 1 through 4.

The **Hydra Figure 8** braking system is utilized by the wheel of the **HydraWinder** coming into contact with the reel. This is achieved by pushing the Tool Circuit lever fully forward. The reel will come to a complete stop preventing the cable from backlashing. If a more gradual stop of the reel is preferred, the speed can be adjusted by turning the **HydraWinder** needle valve control.

13. Move the **HydraWinder** wheel 1" - 2" away from the reel for optimal stopping.

